



BLUMENBECKER

WE DELIVER SOLUTIONS

AUTOMATION TECHNOLOGY ENGINEERING INDUSTRIAL TRADE INDUSTRIAL SERVICE **TECHNICS**

LOAD SENSOR & TRACKING SYSTEM



MESH-GSE LOAD SENSOR

Blumenbecker has already had the field-proven „wired load sensor“ for detecting ULDs and/or pallets in its range since 2019.

THE FUTURE IS MESH

From 2023, Blumenbecker will offer the “MESH load sensor” to transmit the loading/unloading information to the tracking unit via wireless technology. MESH technology via Wirepas has the advantage that many loading sensors (or other Wirepas devices) communicate with each other (a so-called MESH network), thus significantly improving transmission quality and data security.



- | Radio transmission via Wirepas mesh technology
- | Battery life: 8-10 years (as mesh endpoint)
- | Recognition of loads such as ULD or pallets
- | Load detection in all weather conditions

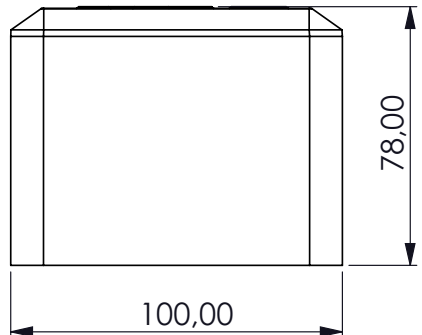
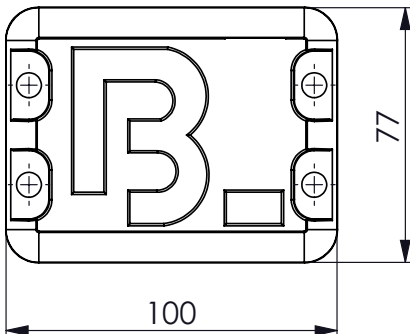

TRACKING SYSTEM

**Solar powered – No Maintenance –
No Cables – 60s Real Time Tracking –
Wireless Mesh****



Airports are very tough environments for any type of equipment but especially for electronic asset tracking devices. Only the best can survive. Another requirement is real time tracking in movement, i.e. every 60 seconds a current GPS-precise location. In order to keep operational costs to a minimum, maintenance-free operation with maximum longevity is required. Last but not least, optionally, cargo monitoring by wireless Mesh sensors** (one or more for individual ULD detection), manual status reporting by ground staff (e.g. for passenger package GTE) and special holders (e.g. full protection for pushrod usage) are available. 'mecSOLAR gte' is a complete solution which fulfills all these requirements in a unique way. Its robustness is airport field-proven. for many years.

| Verfügbare Funktion | mecSOLAR gte |
|---|---|
| modem type | Quectel BG95 |
| solar panel (hail-proof) | ✓ |
| full operation without sunshine (solar panel) | >6 months* >6.000 (14 Ah) / >10.000 (22 Ah) pings |
| rechargeable battery | ✓ |
| M2M SIMchip included | ✓ |
| global positioning technology | GPS (optional GLONASS) |
| cell-ID tracking | ✓ |
| wireless sensor support | ● |
| mount sensor | ● |
| cargo sensor (wireless or cable) | ● |
| short cycled movement tracking | ✓ |
| IP69k | ✓ |
| 5 years warranty | ● |
| ATEX Zone 2 / IECex | ● |
| Bluetooth 5** | ✓ |
| Wirepas IoT protocol** | ✓ |
| click holder | ● |
| cable-based door sensor | ● |
| cable-based temperature sensors | ● |
| suitable for airports | ✓ |
| special holders for GTE | ✓ |
| special holder for pushrod | ✓ |
| bundled transmission | ✓ |

* based on typical object movement profile for land logistics (15 min tracking, 6-8 h/day movement, approx. 21 workdays/month)

** Wireless Mesh only available for 22 Ah

✓ Feature available

● Optional feature

PRODUCTS AND SERVICE FROM A SINGLE SOURCE.

Blumenbecker has been developing and building technology for airports for over 30 years. Thanks to this experience, we are able to understand your requirements and build the product that best suits your processes.

Our airport ground support equipment

- | Luggage and cargo trailers
- | Dollies
- | Aircraft stairs
- | Airfield Special Equipment

Blumenbecker Technik GmbH, Bahnhofstraße 11b, 06246 Bad Lauchstädt, Germany
T: +49 34636 714-0, F: +49 34636 714-29, bt@blumenbecker.com, www.bt.blumenbecker.com